

REVISIONS			
REV.	DESCRIPTION	DATE	APPROVED
A	INITIAL RELEASE	2/13/2014	

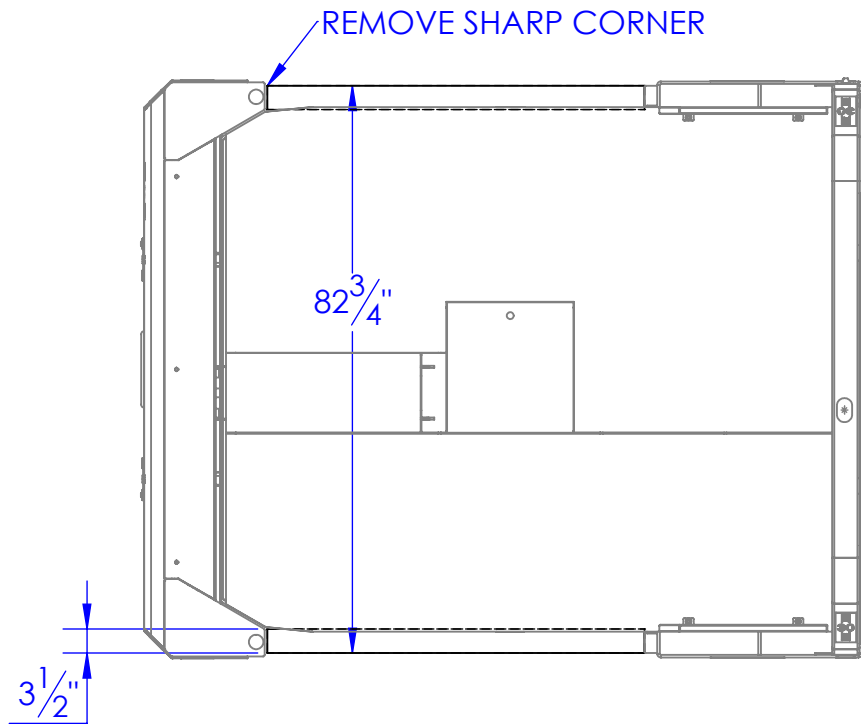

FI .25 x 3.5 L 55  
LENGTH: 55"  
13.65

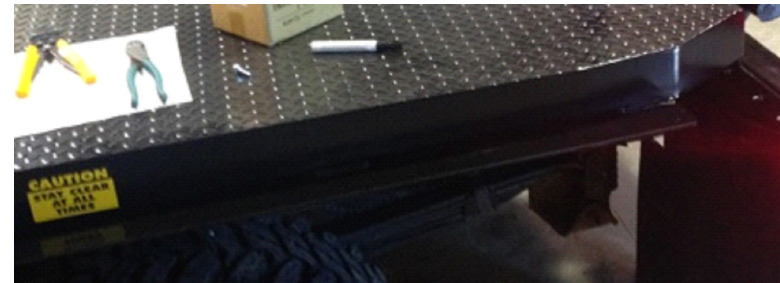
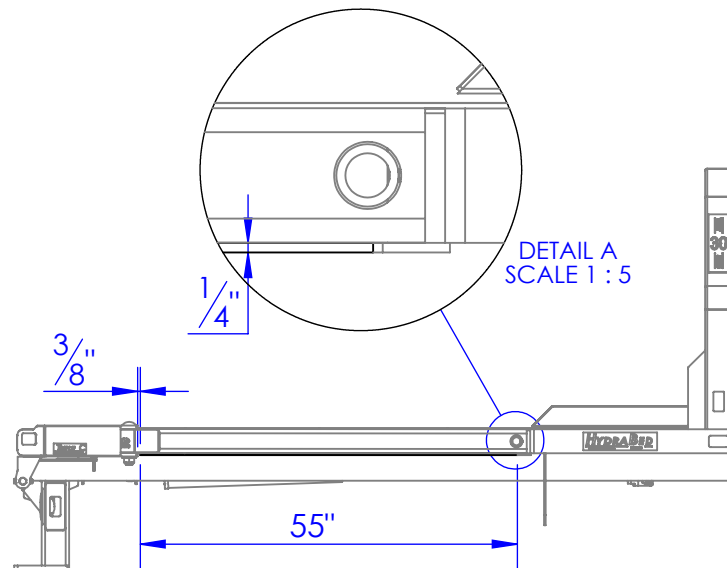
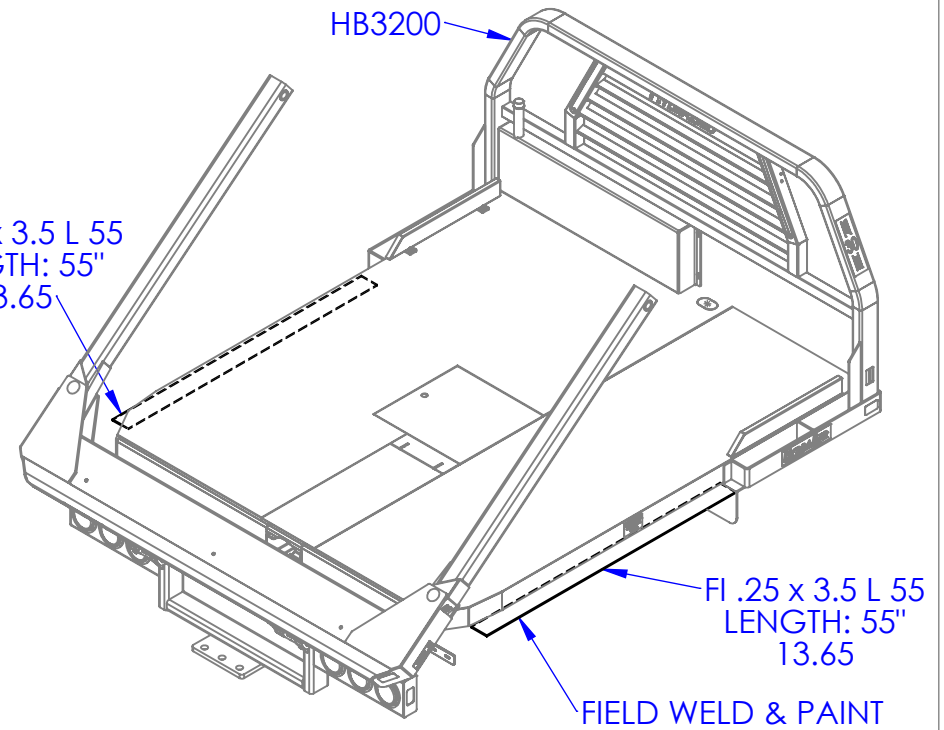

**PROPRIETARY AND CONFIDENTIAL**  
THE INFORMATION CONTAINED IN THIS  
DRAWING IS THE SOLE PROPERTY OF TRIPLE  
C INC. ANY REPRODUCTION IN PART OR  
AS A WHOLE WITHOUT THE WRITTEN  
PERMISSION OF TRIPLE C INC. IS PROHIBITED.

DIMENSIONS ARE IN INCHES TOLERANCES: FRACTIONAL $\pm 1/16$ ANGULAR: MACH $\pm 1$ BEND $\pm$ TWO PLACE DECIMAL $\pm 0.10$ THREE PLACE DECIMAL $\pm 0.05$	
MATERIAL	---
DO NOT SCALE DRAWING	

NAME	DATE
DRAWN <b>HEATH</b>	2/14/2014
PART #	
ASM #	OP-FB-384
COMMENTS: FILLER BAR, HB3200 & HB3300	

P.O. BOX 248,  
SABETHA, KS 66534

**TRIPLE C**  
INC.

SIZE <b>A</b>	DWG. NO. <b>90-0220</b>	REV. <b>A</b>
SCALE: 1:28	WEIGHT: ---	SHEET 1 OF 1